



## 2300 SERIES TIMER AND HOUSING ASSEMBLY

The 2300 series timer and housing assembly is a complete self contained coin control system for the timing control of any electrical device . . .

### SOME OF ITS MANY OUTSTANDING FEATURES

- An adjustable ELECTRONIC time cycle up to 5 minutes . . .
- Equipped with a Coin Acceptor for optimum slug protection . . .
- Can handle a current load up to 5 amps, non-inductive . . .
- Available for nickel, dime or quarter operation . . .
- Two available coin return cup placements, front or side . . .
- Three available coin insert variations, front, side or top . . .
- Double cammed lock for greater protection . . .
- Extra large cash box . . .
- Optional coin return electro-magnet . . .
- Optional Counter Assembly . . .



COIN ACCEPTORS, INC.  
4946 Daggett Ave., St. Louis, Mo. 63110

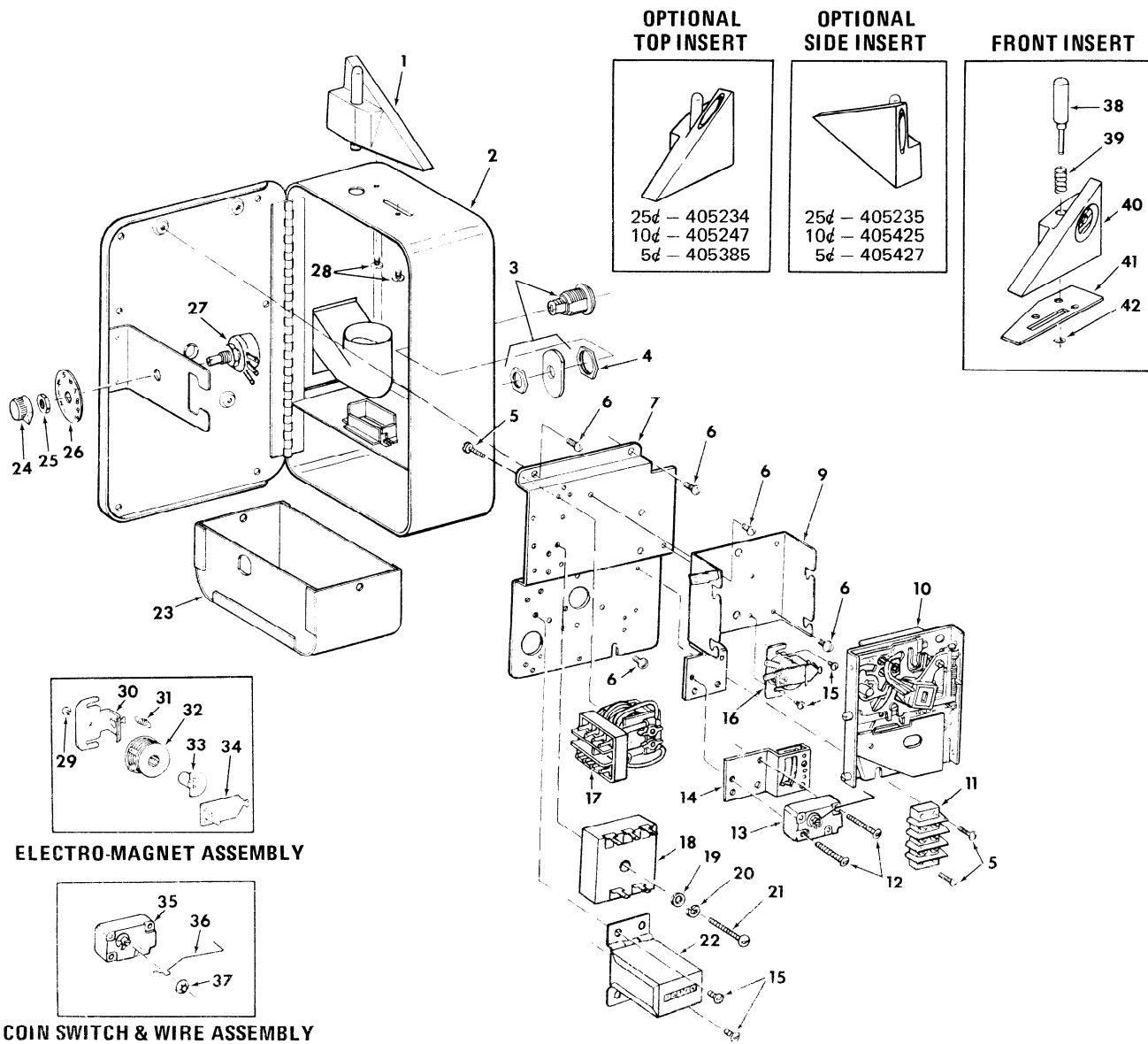

**OPTIONAL TOP INSERT**

25¢ - 405234  
10¢ - 405247  
5¢ - 405385

**OPTIONAL SIDE INSERT**

25¢ - 405235  
10¢ - 405425  
5¢ - 405427

**FRONT INSERT**

38  
39  
40  
41  
42

**ELECTRO-MAGNET ASSEMBLY**

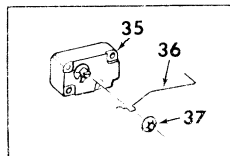

**COIN SWITCH & WIRE ASSEMBLY**

INDEX NO.	PART NO.	DESCRIPTION	QUANTITY
1	405122	25¢ Coin Insert Assembly Front	1
	405113	10¢ Coin Insert Assembly Front	1
	405121	5¢ Coin Insert Assembly Front	1
2	404003	Housing and Side Cup Assembly	1
	404004	Housing and Front Cup Assembly (Not Illustrated)	1
3	950596	Lock	1
4	950128	Lock Retaining Nut	1
5	110-6-6	#6-32 x 3/8" Truss Head Screw	3
6	110-8-3	#8-32 x 3/16" Truss Head Screw	5
7	903371	Base Plate	1
8		OPEN	
9	405133	Channel and Latch Assembly	1
10	Q530-3	25¢ Acceptor	1
	D520-3	10¢ Acceptor	1
	N510-3	5¢ Acceptor	1
11	950300	Terminal Strip	1
12	901056	Switch Screws	2
13	403720	25¢ Coin Switch and Wire Assembly	1
	403740	10¢ Coin Switch and Wire Assembly	1
	403741	5¢ Coin Switch and Wire Assembly	1
14	950127	Switch Chute	1
15	110-6-2	#6-32 x 1/8" Truss Head Screws	4
16	405226	Flat Electro-magnet Assembly	1
17	950795	D.P.D.T. Relay	1
18	903368	Electronic Timer	1
19	600-8	Washer	1
20	610-8	Lock Washer	1
21	100-8-16	#8-32 x 1" Round Head Screw	1
22	404007	Counter Assembly	1

INDEX NO.	PART NO.	DESCRIPTION	QUANTITY
23	950589	Cash Box	1
24	903367	Knob	1
25	903370	7/16 Hex Nut 3/8"-32	1
26	903366	Dial Plate	1
27	903369	Potentiometer	1
28	108-8-4	#8-32 x 1/4" Binding Head Screw	2
29	108B5-4	#5-40 x 1/4" Brass Binding Head Screw	1
30	900691	Electro-magnet Frame	1
31	900693	Electro-magnet Armature Spring	1
32	900827	Electro-magnet Coil	1
33	400635	Core and Ring Assembly	1
34	405117	Electro-magnet Armature	1
35	902050-15	Coin Switch 25¢	1
	902050-9	Coin Switch 10¢	1
	902050-15	Coin Switch 5¢	1
36	950295	25¢ Coin Switch Wire	1
	950294	10¢ Coin Switch Wire	1
	950293	5¢ Coin Switch Wire	1
37	900651	Switch Wire Retainer	1
38	950223	Plunger	1
39	950225	Spring	1
40	950254	Insert 25¢ Front	1
	950255	Insert 10¢ Front	1
	950253	Insert 5¢ Front	1
41	950224	Gasket	1
42	751-15	Retaining Ring	1
	404002	Harness Assembly (Not Illustrated)	1
	950333	25¢ Price Decal (Not Illustrated)	1
	950332	10¢ Price Decal (Not Illustrated)	1
	950812	5¢ Price Decal (Not Illustrated)	1