

**VERTICAL 8 COIN CHUTE**

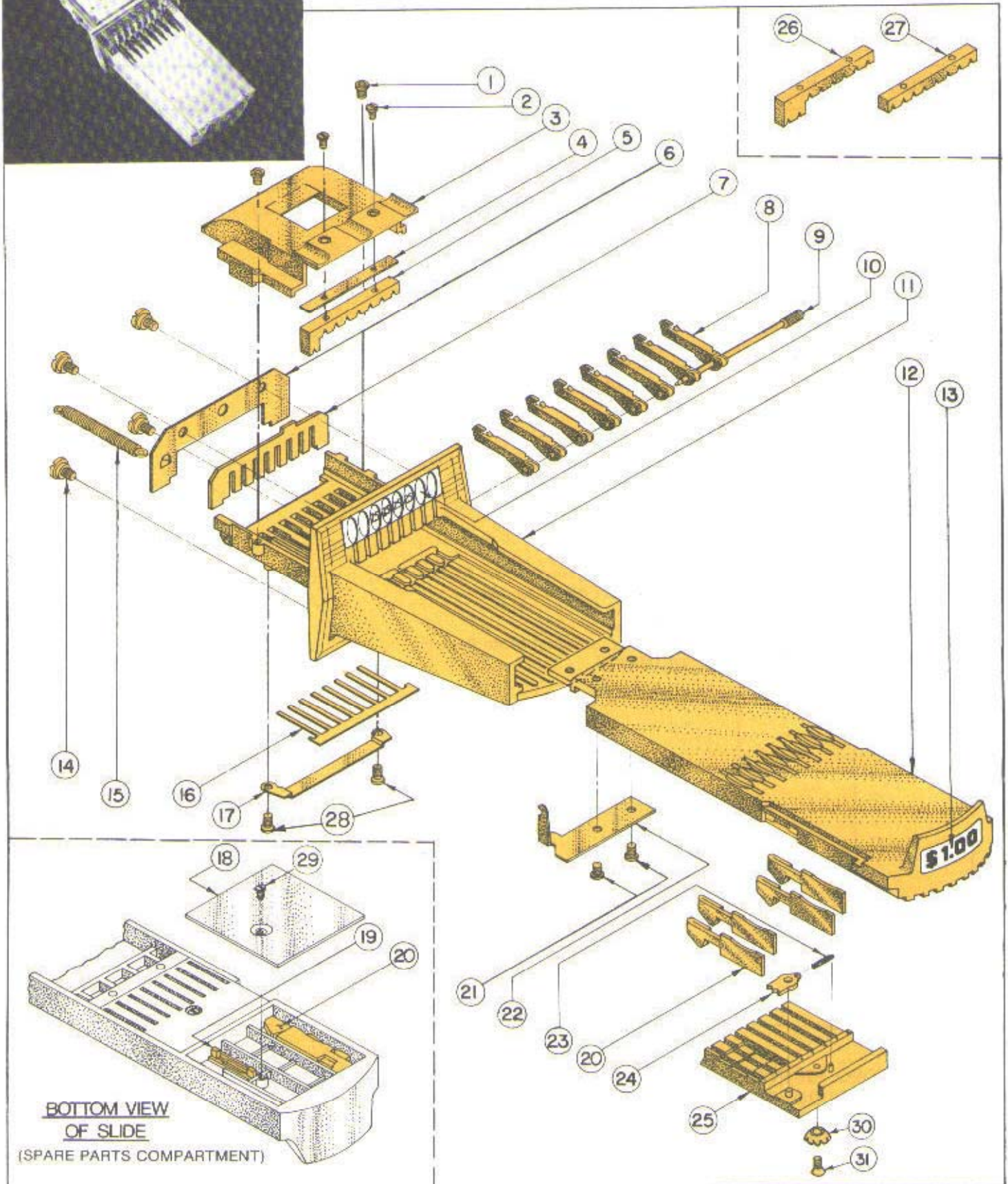
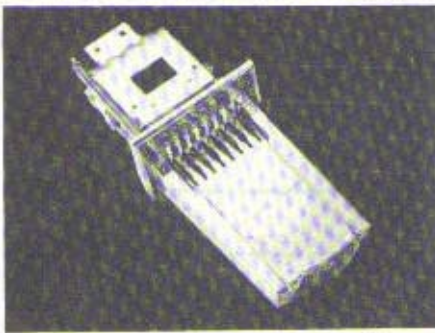

**BOTTOM VIEW  
 OF SLIDE**  
 (SPARE PARTS COMPARTMENT)

# VERTICAL 8 COIN CHUTE

PART NO. 20-1000 (STANDARD U.S. CHUTE)

PART NO. 20-1015 (STANDARD CANADIAN CHUTE)

ITEM	REQ'D	PART NO.	DESCRIPTION
1	2	00-7924	Screw (Metric)
2	2	00-7928	Screw (Metric)
3	1	20-3002	Top Housing
4	1	20-2002	Spacer (For Canadian Chutes Only)
5	1	20-3007	Coin Sizing Block (For 7 Quarters and One Dime)
6	1	20-2006	Gate Cover
7	1	20-2000	Gate
8	8	20-2011	<b>Slide Stop Dog</b>
9	1	20-4000	Dog Shaft
10	1	00-9905	Casting Decal (Specify Coin Denomination)
11	1	20-1002	Body Casting
12	1	20-3001	Coin Slide
13	1	00-9104	Slide Decal (Specify Coin Denomination)
14	4	61-55	Chute Locating Screw
15	1	00-8148	Slide Return Spring
16	1	20-2001	Spring
17	1	20-2007	Spring Protector
18	1	20-2003	Storage Compartment Cover
19	NOTE 1	20-5001	10¢ Insert
20	NOTE 2	20-2010	Blockout Key
21	2	00-7929	Screw (Metric)
22	1	20-2004	Slide Stop
23	1	00-8123	Ratchet Dog Spring
24	1	20-2008	Slide Ratchet Dog
25	1	<b>20-3003</b>	Coin Receiver Block
26	NOTE 3	20-3008	Coin Sizing Block (For 6 Quarters & 2 Dimes)
27	NOTE 3	20-3006	Coin Sizing Block (For 8 Quarters)
28	2	00-7931	Screw (Metric)
29	1	00-7932	Screw (Metric)
<b>30</b>	<b>1</b>	<b>00-7934</b>	<b>Lock Washer, external tooth (Metric)</b>
<b>31</b>	<b>1</b>	<b>00-7933</b>	<b>Screw (Metric)</b>

**NOTES:**

- ONE OR TWO 10¢ INSERTS REQUIRED, DEPENDING ON COIN DENOMINATION.
- NUMBER OF BLOCKOUT KEYS VARIES DEPENDING ON COIN DENOMINATION. (TWO EXTRA BLOCKOUT KEYS ARE STORED INSIDE THE SPARE PARTS COMPARTMENT REGARDLESS OF COIN DENOMINATION).
- COIN SIZING BLOCKS, P/N 20-3008 AND 20-3006, ARE NOT SUPPLIED WITH STANDARD CHUTE.